

# CENTRAL HYDRAULICS INC.

•Daytona Beach •Cocoa •Leesburg •Ocala •Tampa 1-800-264-9571

## Hydraulic Gear Pump

### 3/4" LONG KEYED SHAFT

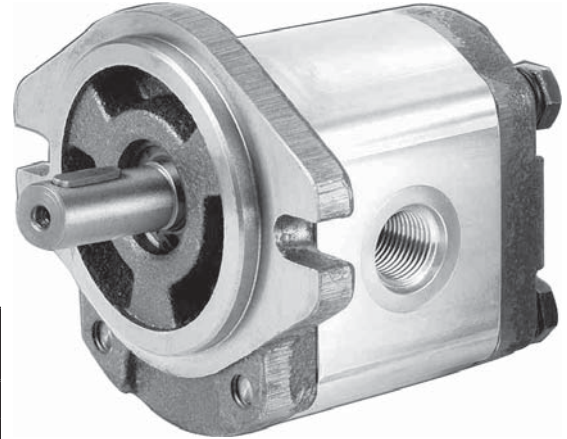

#### Performance Data

PART # (L)CW (R)CCW	ci.	Max PSI	GPM@ 1800rpm	PORT
2GG9U05L	.30	4200	2.34	<b>INLET</b> #20 ORB 1-5/8"-12
2GG9U05R	.30	4200	2.34	
2GG9U07L	.43	4200	3.35	
2GG9U07R	.43	4200	3.35	
2GG9U08L	.52	4200	4.05	
2GG9U08R	.52	4200	4.05	
2GG9U09L	.58	4200	4.52	
2GG9U09R	.58	4200	4.52	
2GG9U11L	.69	4200	5.38	
2GG9U11R	.69	4200	5.38	
2GG9U14L	.85	4200	6.62	<b>OUTLET</b> #16 ORB 1-5/16"-12
2GG9U14R	.85	4200	6.62	
2GG9U16L	.98	4200	7.63	
2GG9U16R	.98	4200	7.63	
2GG9U18L	1.10	4200	8.57	
2GG9U18R	1.10	4200	8.57	
2GG9U20L	1.20	4200	9.35	
2GG9U20R	1.20	4200	9.35	
2GG9U22L	1.31	4200	10.20	
2GG9U22R	1.31	4200	10.20	
2GG9U24L	1.44	3000	11.22	<b>INLET</b> #16 ORB 1-5/16"-12
2GG9U24R	1.44	3000	11.22	
2GG9U26L	1.53	3000	11.92	
2GG9U26R	1.53	3000	11.92	
2GG9U28L	1.71	3000	13.32	
2GG9U28R	1.71	3000	13.32	
2GG9U30L	1.84	3000	14.34	
2GG9U30R	1.84	3000	14.34	
2GG9U33L	2.02	3000	15.74	
2GG9U33R	2.02	3000	15.74	

2G cast iron pump covers ensure up to 3500 psi working pressure. The extruded body and pressure loaded bearing blocks are made from the highest quality aluminum. Precision machined ne peice steel gears guarantee the highest performance standard available. Honor gear pumps are well suited for both industrial and mobile applications, and are very competitive so you can meet the competition with a good price advantage.